

# PROVISIONAL SPECIFICATION

## LAGOON 400

(STANDARD VERSION)





**PROVISIONAL SPECIFICATION LAGOON 400  
(GB-STANDARD VERSION)**



## **CONSTRUCTION**

- Polyester and vinylester resin construction (osmotic barrier)
- Infused Balsa cored hull construction - white gelcoat
- Below the waterline: infused Hull bottom in solid GRP
- Infused Balsa cored deck and bridgedeck construction
- Solid glass or core-mat sandwich one-piece countermold
- Laminated wooden bulkheads either tabbed or glued

## **SAILS**

- 1 fully-roached mainsail, sail area 58 m<sup>2</sup>/624 sq.ft. and battens
- 1 furling genoa, sail area 37 m<sup>2</sup>/398 sq.ft. with UV protective band

## **STANDING RIGGING**

- Anodized aluminium mast, P : 15.66m/51'5'' deck stepped, (mast clearance : 20.30m / 66'7'')
- Single spreader rig
- Anodized aluminium boom
- 2 hull-mounted shroud chain plates
- 1 crossbeam-mounted forestay chain plate

## **RUNNING RIGGING**

- 1 double purchase mainsail halyard
- 1 genoa halyard
- 1 multi-purchase mainsail sheet and traveller on hard top, running back to the helm station
- 2 genoa sheets running back to the helm station
- 2 genoa sheet tracks with adjustable fairlead cars
- 3 winches at the helm station
  
- 1 winch, 46.2 ST for:
  - 1 main sail halyard
  - 1 genoa halyard
  - Genaker halyard and sheets (option)
  - 1 boom topping lift
  - 1 genoa furling line
  
- 1 winch, 46.2 ST for:
  - 1 main sail sheet
  - Reef 1 single line
  - Reef 2 single line
  - Reef 3 single line
  
- 1 winch, 46.2 ST for:
  - 1 port side genoa sheet
  - 1 port side main sail traveller line
  - 1 starboard main sail traveller line
  
- 1 fixed mainsail outhaul

- 1 stopper for genoa furling line on deck
- 2 lazy jacks adjustable at mast base
- 2 winches handle with holder

## **HARDWARE**

- 8 mooring cleats
- 12V/1000w electric anchor windlass in anchor locker with 3/8 Gipsy
- Bow safety net with knot-less nylon netting
- Inboard stern stainless steel pulpits
- Outboard stern stainless steel pulpits with horseshoe buoy mount and flag pole on one side
- Composite forward longitudinal beam with integral chain run and mooring cleat
- Aluminium crossbeam with forestay chainplate, anchor roller and 1 nav light
- Stanchions (bow pulpits are optional)
- Double level stainless steel lifelines
- Triple level stainless steel lifelines on aft beam
- Stainless steel roof-mounted handrails
- Stainless steel hard top feet-mounted handrails

## **COCKPIT**

- Cockpit used as outdoor salon, access to the sea by a stern walkway giving access to the transoms
- Hard top bimini with 3 integrated spotlights
- Self bailing cockpit
- Helm station on port side on the roof bulkhead : engine throttle controls, engine control panels, compass, room for electronic equipment, leather covered steering wheel with brake, double helmseat with cushions, access steps from cockpit with s/s handrail, line storage compartment
- Steering system: cable steering, s/s shaft rudders, emergency tiller
- U shape seating area on starboard
- Varnished wooden cockpit table interchangeable with salon coffee table
- 1 aft cockpit seat locker
- 1 technical locker (for the optional generator)
- 1 Butane locker under the seats on starboard side of cockpit
- 1 locker under the lazy boy in cockpit \_ with room to store 1 additional butane tank

## **FOREDECK**

- Forward seating area.
- Anchor chain locker with large opening on gas strut
- Forward bow lockers with locking deck hatches and access ladders
- Anchor roller on aluminium cross beam

## **TRANSOMS**

- Hot and cold deck shower on port
- Port side s/s swim ladder
- 1 handrail on each transom
- Rubber transom rubrails
- Access to engine room

- Recessed step on hull side

## **DECORATION**

- Hull water line: Lagoon 400 boot stripe
- Lagoon stickers on roof

## **ENGINE COMPARTMENT**

- Access from opening hatch with stainless steel gas strut in transom
- 2 x 29 hp sail drive diesel
- Engine shut off valve at helm station
- Double engine throttle control at helm station
- Sound proofed engine compartment
- Engine compartment air intake on aft crossbeam
- Engine compartment 12V blowers
- 1 engine start battery 12V – 70 Ah
- Fuel filter with water separator
- Raw water filter
- Exhaust with muffler

## **PLUMBING**

- 1 X 300 L / 1 X 79 gal. water tanks in front locker (Optional: 1 additional 300L / 1 x 79gal. additional water tanks)
- Fresh water circuit and 12V pump located in port forward cabin
- Hot water circuit with 40 L / 11 gal. electric water heater, 220/110V or starboard engine heat exchanger
- Rotomolded Diesel tanks: 2 X 200 L / 2 x 53 gal. under starboard and port aft berth
- 2 x 12V automatic or manually activated electric bilge pumps
- 2 x manual bilge pumps in cockpit

## **ELECTRICITY**

- 12 V backlit electrical panel on port side of salon
- LCD display with: voltmeter, Amp-meter, water level gauge, diesel level gauge, low level alarm for house batteries
- 2 house batteries: 12V - 140 Ah
- Battery switches: house bank: under bed in aft port cabin  
Engine start: under bed in aft port & stbd cabin

## **INTERIOR LAYOUT**

### **GENERAL**

- Interior woodwork in marine plywood and light oak alpi veneer with horizontal wood grain
- Synthetic laminated floor. Colour: walnut

## **2 VERSIONS**

### **• OWNER**

3 cabins, 3 toilets, 1 separate shower stall in owner washroom

### **• CHARTER**

4 cabins , 4 toilets

## **Salon**

- Large panoramic view salon with glass sliding door and lock
- Standing headroom: 2.13m / 7'
- 7 X 12V halogen salon overhead lights
- Seating for 5 people
- Varnished wood coffee table that can be swapped with large wooden cockpit table.  
1 set of tall aluminum legs and 1 set of short aluminum legs.
- 3 storage compartments under settee
- 2 opening hatches in forward vertical roof windows

## **Chart table**

(On the starboard side on the salon, facing forward)

- Standing headroom: 1.84m / 6'
- 1 X 12V halogen overhead light
- Panel for (optional) electronic equipment installation
- 1 seat
- Opening chart table
- 12V chart reading light

## **Galley**

In salon communicating directly with cockpit via a sliding glass window

- Standing headroom: 2.09 m / 6' 10"
- 3 X 12V halogen overhead lights
- White laminate countertop with wooden fiddles
- Double S/S sink with hot and cold mixer tap
- Drainer counter for dish drying
- 3 burner butane stove
- Separate oven with grill (enamelled interior)
- 2 drawers
- Cupboard under sink with trash can behind door
- Starboard galley column with separate enamelled butane oven / with broiler and cabinet for microwave oven (optional).
- 1 x12V fridge 110 L / 29 Us gal
- Storage under countertop, which can accommodate an additional optional refrigerator 110 L/ 29 Us gal or a freezer 110L/ 29 Us gal

## **Companionways**

- Laminated wood steps colour: walnut
- Escape hatch under steps
- 1X 12V halogen salon overhead lights

## **Port Hull**

### **Forward port Cabin**

- Entrance from port gangway
- Standing headroom: 2.08m / 6' 10"
- 2X 12V halogen overhead lighting
- 2X 12V halogen reading lights on the ceiling

- Double bed convertible in 2 single beds
  - Double bed: 2.06m X 1.76 m x 1.16m- / 6' 9" X 5'9" x 3'10"
  - 2 single beds: 2.06m X 0.69 m x 0.58m- / 6' 9" X 2'3" x 1'11"
- 1 drawer and 2 lockers on front of bed
- Storage lockers under the bed
- Night stands with storage on both sides of bed
- 1 hanging locker
- 1 opening deck hatch with blind
- 1 opening port hull with curtain
- 1 large one-way window with curtain

### **Forward port head**

- Access from forward port cabin
- 2X 12 v halogen overhead lighting
- Standing headroom: approx 2.00m/ 6'7"
- Large manual marine head (cabinet for optional holding tank with gravity drain/ and deck pump out)
- Fiberglass washbasin with hot/cold mixer tap,
- 1 fiberglass grating in the shower
- 1 shower head holder
- 1 chrome towel holder
- 1 chrome double towel hook
- Shower sump pump with float switch
- 1 opening deck hatch with blind
- 1 toilet paper holder under the sink
- 1 cabinet with mirrors on doors
- 1 cup in the cabinet above the sink

### **Aft port head**

- Access from aft port cabin
- 2X 12 v halogen overhead lighting
- Standing headroom: approx 2.00m/ 6'7"
- Large manual marine head + standard holding tank with gravity drain/deck pump out
- Fiberglass washbasin with hot/cold mixer tap,
- 1 fiberglass grating in the shower
- 1 shower head holder
- 1 chrome towel holder
- 1 chrome double towel hook
- Shower sump pump with float switch
- 1 opening deck hatch with blind
- 1 toilet paper holder under the sink
- 1 cabinet with mirrors on doors
- 1 cup in the cabinet above the sink

### **Aft port Cabin**

- Entrance from Port gangway
- Standing headroom: 2.00m / 6' 7"
- 2X 12V Halogen overhead lighting



- 2X 12V Halogen reading lights on the ceiling
- "Semi - island style" bed with front and side access 2.00m X 1.44 x 1.00 m / 6' 7" X-4'9"x 3' 3"
- 1 drawer under the bed
- Access to batteries switches
- Storage lockers under the bed
- Night stands with storage on both sides of berth
- 1 hanging locker
- 1 opening deck hatch with blind
- 1 hull port with curtain
- 1 large one-way window with curtain

## **Starboard hull (4 cabins version)**

### **Forward Starboard cabin**

- Entrance from starboard gangway
  - Standing headroom: 2.08m / 6' 10"
  - 2x12V Halogen overhead lighting
  - 2x12V Halogen reading lights on the ceiling
  - Double bed convertible in 2 single beds
- Double bed: 2.06m X 1.76 m x 1.16m / 6' 9" X 5'9" x 3'10"
- 2 single beds: 2.06m X 0.69 m x 0.58m/ 6' 9" X 2'3" x 1'11"
- 1 Drawer and 2 lockers on front of bed
  - Storage lockers under the bed
  - Night stands with storage on both sides of berth
  - 1 hanging locker
  - 1 opening deck hatch with blind
  - 1 opening port hull with curtain
  - 1 large one-way window with curtain

### **Forward starboard head**

- Access from forward starboard cabin
- 2X 12 v halogen overhead lighting
- Standing headroom: approx 2.00m/ 6'7"
- Large manual marine head (cabinet for optional holding tank with gravity drain and deck pump out)
- Fiberglass washbasin with hot/cold mixer tap,
- 1 fiberglass grating in the shower
- 1 shower head holder
- 1 chrome towel holder
- 1 chrome double towel hook
- Shower sump pump with float switch
- 1 opening deck hatch with blind
- 1 toilet paper holder under the sink
- 1 cabinet with mirrors on doors
- 1 cup in the cabinet above of the sink

### **Aft starboard head**

- Access from aft starboard cabin
- 2X 12 v halogen overhead lighting
- Standing headroom: approx 2.00m/ 6'7"
- Large manual marine head (cabinet for optional holding tank with gravity drain/ and deck pump out)
- Fiberglass washbasin with hot/cold mixer tap,
- 1 fiberglass grating in the shower
- 1 shower head holder
- 1 chrome towel holder
- 1 chrome double towel hook
- Shower sump pump with float switch
- 1 opening deck hatch with blind
- 1 toilet paper holder under the sink
- 1 cabinet with mirrors on doors
- 2 cups in the cabinet above of the sink

### **Aft starboard Cabin**

- Entrance from starboard gangway
- Standing headroom: 2.00m / 6' 7"
- 2X 12V Halogen overhead lighting
- 2X 12V Halogen reading lights on the ceiling
- "Semi - island style" bed with front and side access 2.00m X 1.44 x 1.00 m / 6' 7" X 4'9"x 3' 3"
- 1 drawer under the bed
- Access to batteries switches
- Storage lockers under the bed
- Night stands with storage on both sides of berth
- 1 hanging locker
- 1 opening deck hatch with blind
- 1 opening port hull with curtain
- 1 large one-way window with curtain

## **Starboard hull (3 cabin version)**

### **OWNER'S VERSION**

#### **Owner's cabin on starboard (entire length dedicated to owner)**

- Entrance from salon through sliding door
- Standing headroom: 1.98m / 6' 6"
- 6X 12V Halogen overhead lighting
- 2X 12V Halogen reading lights on the ceiling
- "Semi - island style" bed with front and side access 2.00m X 1.44 x 1.00 m / 6' 7" X-4'9"x 3'3"
- 1 drawer under the bed
- Access to battery switches
- Night stands with storage on both sides of berth
- 1 hanging locker

- 1 cabinet with shelves
- Access to emergency escape hatch
- 3 opening deck hatches with blinds
- 1 opening port hull curtain
- 1 large one-way window with curtain
- 1 desk with seat
- 1 locker with shelves on outboard side
- 1 locker for washer/dryer (optional)
- 1 high cabinet with 4 doors on inboard side

### **Owner's head**

- Access from owner's cabin
- 3X 12 v halogen overhead lighting
- Standing headroom: approx 2.01 m or 6' 7"
- Large manual marine head (storage for option holding tank with gravity drain/deck pump out)
- Fiberglass washbasin with hot/cold mixer tap,
- 1 low locker with shelves
- 1 opening deck hatch
- 1 large one-way window with curtain
- 1 cabinet with 4 doors and mirrors above the sink
- 1 light on the cabinet
- 1 chrome double towel hook
- 1 chrome towel holder
- 1 chrome toilet paper holder
- 2 cup in the cabinet-above the sink

### **Forward port shower**

- Separate Shower stall
- Standing headroom: 2.03 m / 6'8"
- 1 opening port hull
- 1 12v spotlight
- 1 shower head holder with soap holder
- 1 shower grating
- Shower sump pump with float switch
- Hot and cold shower mixer tap

### **MATTRESS AND UPHOLSTERY**

- Cabins mattresses: marine mattress made of multi layer alveolar foam with several densities. Mattress made to improve comfort for a deeper sleep (thickness: 120mm\_ 5'')
- Mattress treated: anti-microbial, anti-bacterial, non allergenic, anti-dust mite
- Standard upholstery as indicated on samples
- Synthetic fabrics adapted to marine environment:
  - washable fabric (40°C)
  - fabrics are sun resistant
  - fabrics are water repellent, which includes anti stain treatment
- Fabric hull liner in cabins

- Fiberglass counter mold in salon, in cabins and wash rooms
- Curtains in cabins and on forward windows in salon

### **US Specification:**

Boats sold in America include the following equipment s as standard features:

- 110 V heating element in water heater
- 1 holding tank with gravity drain/deck pump out in each head
- Windlass gipsy for US measurement chain
- Propane gaz system for US

# LAGOON 400

## Design

**Length over all**  
**Length water line**  
**Beam**  
**Draft**  
**Mast clearance**  
**Height keel-roof**  
**Waterline - nacelle clearance**

**Van Peteghem-Lauriot Prévost**  
11.97 m / **39' 3"**  
11.45 m / **37' 7"**  
7.25 m / **23' 9"**  
1.21 m / **4'**  
20.30m / **66' 7"**  
4.49 m / **14' 9"**  
0.547 m à 0.700 m / **1'10" to 2'4"**

**Empty displacement**  
**Light displacement (EEC)**  
**Max. loaded displacement**

9.740 t / **21477 Lbs**  
10,220 t / **22535 Lbs**  
14,105 t / **31102Lbs**

## Engine

2 x 29 cv en std / **standard 2 x 29 HP**

**Fuel capacity**  
**Transmission**

2 x 200 L / **2 x 53 US gal**  
**S.drive**

## Sail

**Sail area**  
**Full-batten mainsail**  
**Furling genoa**  
**Furling staysail**  
**Storm jib**  
**Optional spinnaker**  
**Optional gennaker**  
**I**  
**J mast front face-forestay** 3.93 m / **12'11"**  
**P mainsail**  
**E boom**

95.5 m<sup>2</sup> / **1028 sq.ft.**  
58m<sup>2</sup> / **624sq.ft.**  
37m<sup>2</sup> / **398sq.ft.**  
non / **no**  
non / **no**  
non / **no**  
75 m<sup>2</sup> / **807 sq.ft.**  
15.63 m / **51'3"**  
  
15.66 m / **51'5"**  
5.31 m / **17'5"**

**Fresh water capacity**  
**Hot water, pressure water**  
**Refrigerator**  
**Freezer**

1 x 300 L / **79 US gal**  
40 l / **11 US gal**  
110 l / **29 US gal**  
Option 110l / **29 US gal**

## Berths

**No. Of berths**  
**Dimensions forward berth**  
- double bed  
- single beds

**6 to 12**  
2,06 x 1,76 x 1,16 m / **6'9" x 5'9" x 3'10"**  
2,06 x 0,69 x 0,58 m / **6'9" x 2'3" x 1'11" 2**

**Dimensions aft berth**

2,00 x 1,44 x 1.00 m / **6'7" x 5' x 3'3"**

**Dimensions owner berth**

2,00 x 1,44 x 1.00 m / **6'7" x 5' x 3'3"**

### Standing headroom

**Salon**

1.84 m à 2.13 m / **6' to 7'**

**Cabin:**

Av : 2.08m - Ar: 2.00 m /

**Fw:6'1" - Aft:6'7"**

**Head:**

Av: 2.00 m - Ar: 2.00m /

**Fw:6'7" - Aft:6'7"**

**Passage way**

2.00 m / **6'7"**

**Tender: MAX STATIC WEIGHT**

3,40 m / **11'2"** - 150 kg / **331 Lbs**

**EC certification**

**A : 12 ; B : 14 ; C : 20 ; D : 20**

### Construction

**Sides : balsa cored sandwich with vinylester and polyester resins**

**Bottom : solid glass with vinylester and polyester resins**

**Deck : balsa cored sandwich with vinylester and polyester resins**

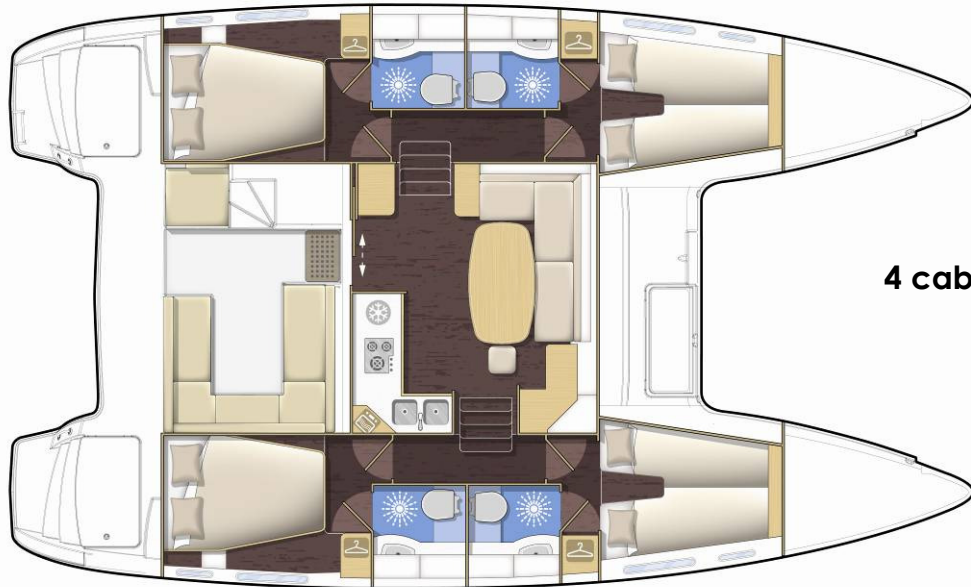

**4 cabins**



**3 cabins**

